

Please read this manual carefully before use.

**Box contents**

- KS Car DAB (A)
- Micro USB Charge Cable (B)
- Active Antenna (C)
- Dual USB Car Charger (D)
- 3.5 mm Aux Cable (E)
- Suction Car Mount (F)
- Self-adhesive Clips (G)

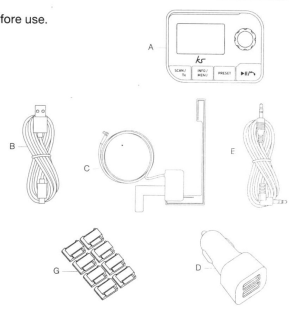

2

**Guidance and general safety instructions**

Due care and attention is required when driving a motor vehicle. The operation of any device whilst driving may cause a lack of attention, and pose a hazard to other road users.

Please follow general safety guidelines before and when using any connected device.

- Do not attempt to connect your product whilst driving
- Ensure your product fits correctly and securely into the power outlet socket before driving
- Do not attempt to adjust or tune your music device whilst vehicle is in motion or operating the controls of the vehicle
- Do not insert any objects other than the correct adaptor into the power outlet without disconnecting the battery of the vehicle
- We do not assume any responsibility for personal injury, or damage incurred due to misuse, or unsafe operating of devices connected to your vehicle or the vehicle's power outlet

Please drive carefully.

4

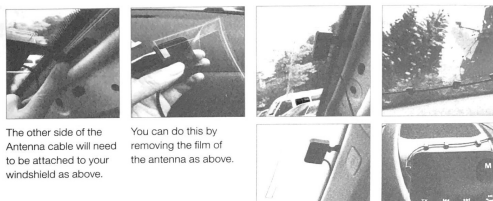

The other side of the Antenna cable will need to be attached to your windshield as above.

You can do this by removing the film of the antenna as above.

The copper foil needs to be in contact with metal and the main part of the unit on the windshield as above.

Once connected to your windshield and plugged into the USB Charger, please use the Self-adhesive Clips (G) to secure the cable as above.

6

**DAB mode**

**When in DAB mode**

- Long press Scan (3) to start scanning the available stations. The Car DAB will automatically go to a DAB station once completed
- To change the station, rotate the MFB (2) or short press Menu (4) to show a full list of available stations and use the MFB (2) to scroll through the list and short press MFB (2) to select

Once you've selected your desired station, this will now be playing over your car stereo.

<b>Adjusting volume</b>	Either use your car stereo or long press the MFB (2) and then rotate to adjust.
<b>Preset a station</b>	Once you've found your desired station, long press Preset (5) to enter the preset list (such as P1, P2, P3...). Rotate MFB (2) to scroll through the preset list and short press MFB (2) to select the desired location.
<b>Finding your presets</b>	Once you've confirmed your preset list, to select a station short press Preset (5) and rotate MFB (2) to find your desired preset and short press MFB (2) to select.

**Note:** Short press Play/Pause (6) to mute in DAB mode.

**Micro SD mode**

- Insert the micro SD card into the Micro SD Card Port (9) and your music will play automatically. Press Play/Pause (6) to play/pause the track.
- While using the Car DAB and connecting up to the USB Car Charger (D), you can use the other USB Charge Output (14) for use on other devices.

**Menu/info controls**

Long press Menu (4) to enter the menu. Rotate the MFB (2) to scroll through the options. Short press MFB (2) to select option. In the option, rotate the MFB (2) and short press MFB (2) to select desired option:

- Delete all presets** - This will delete all the current DAB presets (only used in DAB mode)
- DAB auto scan** - Allows you to automatically scan all stations (only used in DAB mode)
- Languages** - This allows you to change the language
- Backlight** - High and Medium options for the backlight strength
- Bluetooth setting** - To turn Bluetooth setting On/Off
- Button light** - Allows you to control whether the LED lights behind the buttons are On/Off
- Factory reset** - Allows you to factory reset the Car DAB, which will restart the product
- TA message** - Allows you to see traffic alerts from the selected radio station
- Service following** - Picks up local stations when on the move without having to keep rescanning

10

**Specifications**

Bluetooth® v4.2	
Bluetooth range	up to 10 m
FM Frequency	87.6 - 107.9 MHz
DAB/DAB+ frequency	174.928 - 239.200 MHz
USB port 1	5 V 1.0 A
USB port 2	5 V 2.1 A
Transmission power	4.0 dBm
Frequency band	2402 MHz - 2480 MHz
Weight	78 g
Product size (mm)	H62 x W86 x D35.2

12

**Product layout**

1. LCD Display
2. Multifunction Button (MFB)
3. Scan/Transmit
4. Information/Menu
5. Preset
6. Play/Pause/Call Handling
7. Micro USB Charging Port
8. Microphone
9. Micro SD Card Port
10. Antenna Jack
11. Line Out
12. Magnet/Holder
13. 1.0 A USB Charge Out
14. 2.1 A USB Charge Out

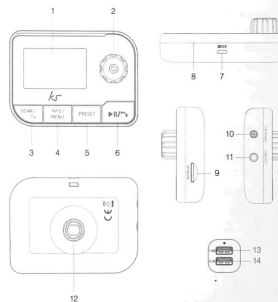

3

**Setting up your Car DAB**

1. Mount the Car DAB on your Dashboard (see Fig.1) or Front Windscreen (see Fig.2). Simply attach the Suction Mount (F) to the Magnet (12) on the back of the Car DAB
2. Plug the USB Car Charger (D) into your car's 12 V port. Insert the Micro USB Charge Cable (B) into your USB Car Charger (D) and the Car DAB's Micro USB Charging Port (7) (see Fig.3)
3. Plug the Antenna (C) into the Antenna Jack (10) (see Fig.3)

Fig.1

Fig.2

Fig.3

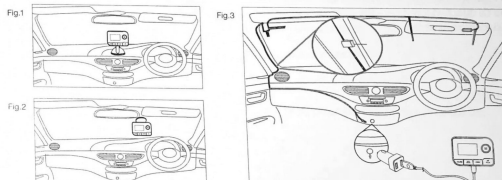

[continued...]

**Connection**

Once the installation is complete and you've connected the Car DAB to power, you will now need to connect the Car DAB to your car stereo by doing one of the below options:

<b>Use via line in</b>	With the Aux Cable (E) provided. Plug one end into your Car's Aux port and the other end into the Car DAB using the Line Out (11) port. Please ensure your car stereo is in aux mode
<b>Use via FM transmit</b>	With your FM radio on, please find an empty FM radio frequency that is clear and has no interference. Short press Transmit (3) which will show the current FM frequency on your Car DAB. Rotate the MFB (2) to scroll through the FM frequencies and match this with your car stereo

By doing either of the above options, you are now ready to use your Car DAB.

**Changing modes**

Short press MFB (2) to scroll through the different modes. Short press MFB (2) on the selected mode.

7

**Bluetooth® mode**

- Once in Bluetooth mode, the Car DAB will automatically enter pairing mode. The Bluetooth symbol in the middle of the top bar on the LCD Display (1) will be flashing
- Turn your device's Bluetooth ON and search for new devices
- Select 'KS Car DAB': If asked for a passcode, enter '0000', and they will be paired
- The Car DAB will automatically pair to the last device it was connected to once turned on
- You can now wirelessly play music from your device

**Playing music via Bluetooth**

- Once connected, play music via your device and it will now play through your Car DAB and onto your car stereo
- Short press Play/Pause (6) to play/pause a track
- Rotate the MFB (2) to scroll through your music
- Short press Call Handling (6) to answer/hang up on a call
- Double press Call Handling (6) to reject a call
- Double press Call Handling (6) to redial last caller

Long press Transmit (3) to break the connection and re-enter pairing mode. The Bluetooth symbol in the middle of the top bar on the LCD Display (1) will be flashing.

9

**Care for your Car DAB**

**Please DON'T:**

- Get the Car DAB wet
- Drop the Car DAB as this will invalidate your warranty
- Open up the Car DAB. There are no user serviceable parts inside
- Expose Car DAB to extreme temperatures or rapid changes of hot to cold or vice versa

**Please DO:**

- Clean the Car DAB with a soft dry cloth and no detergents

**Troubleshooting**

We hope you've now got all the information you need to get started, but if you're having problems with anything, please feel free to contact us at: [support@kitsound.co.uk](mailto:support@kitsound.co.uk)

Hereby, Kondor Ltd declares that the radio equipment type, KSCDABBK KitSound Car DAB, is in compliance with Directive 2014/53/EU. The full text of the EU declaration of conformity is available at the following internet address: <http://kondor.co.uk/product-documents>.

The use and operation of this product is beyond our control. Warranty of the Car DAB is limited to defects caused by faulty manufacture or defects in materials only. No warranty whatsoever is given or implied for damage caused by the user under any circumstances. This does not affect your statutory rights.

Please do not attempt to open this product. There are no user serviceable parts inside. In particular if your product has an embedded, non-replaceable battery, do not attempt to access or remove the battery as this may cause personal injury and will damage the product. Making any attempt to open the product or carry out repair voids any and all warranties.

We are sorry for any inconvenience caused by minor inconsistencies in these instructions, which may occur as a result of product improvement and development.

13